



BUILDING A BETTER I-4

Stay Informed:

- » Project Hotline: 844-ULT-INFO (858-4636)
- » Sign up for email and text alerts at fdot.tips/I4Alerts
- » Follow @i4Ultimate on Twitter
- » View our weekly construction update video at fdot.tips/I4Video
- » Subscribe to our monthly newsletter at fdot.tips/I4News

S.R. 436 RAMP TO EASTBOUND I-4 CLOSING DURING WEEKEND OF JANUARY 19

STATE ROAD (S.R.) 436 ON-RAMP TO EASTBOUND INTERSTATE 4 (I-4) CLOSING FROM 10 PM ON JANUARY 19 UNTIL 5 AM ON JANUARY 22

The Florida Department of Transportation is temporarily closing the S.R. 436 on-ramp to eastbound I-4 for the weekend of January 19. The closure will begin at 10 p.m. on Friday and continue until 5 a.m. on Monday, January 22. The closure is necessary for drainage improvements.

Traveling to eastbound I-4 from S.R. 436, near I-4 interchange:

- Turn north onto Douglas Avenue
- Turn right on S.R. 434
- Turn left onto eastbound I-4 entrance ramp

Traveling to eastbound I-4 from S.R. 436, near Montgomery Road:

- Turn north onto Montgomery Road
- Turn right on S.R. 434
- Turn left onto eastbound I-4 entrance ramp

Traveling to eastbound I-4 on S.R. 436, near S.R. 434:

- Turn north onto S.R. 434
- Turn left onto eastbound I-4 entrance ramp

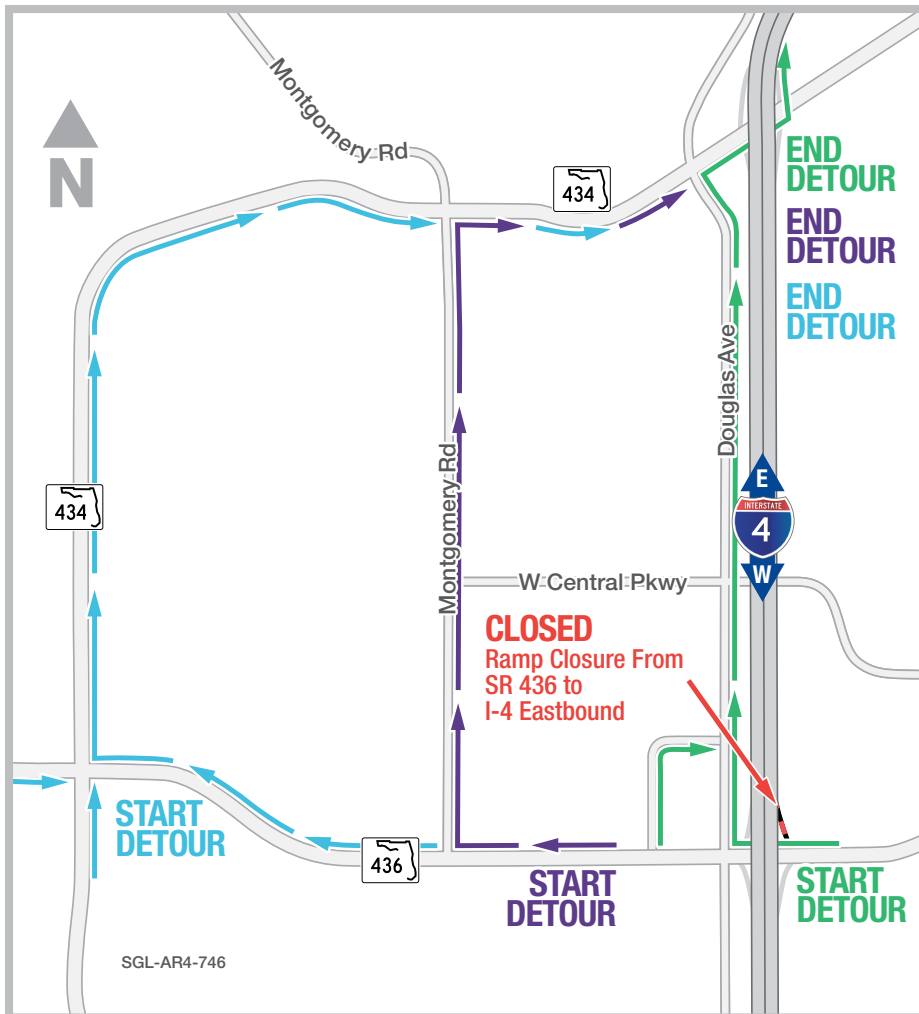

PROJECT INFO

The \$2.3 billion I-4 Ultimate project is reconstructing 21 miles of interstate from west of Kirkman Road to east of State Road 434 in Longwood. For more information about I-4 Ultimate, contact David Parks, I-4 Ultimate Public Information Officer, at 844-ULT-INFO (844-858-4636) or DavidParks@i4Ultimate.com.

Closure subject to change. Construction progress, roadway conditions and weather may require schedule adjustments. Please check i4ultimate.com/alertsmap for the most up-to-date information.



Sign up for I-4 Construction Updates and Alerts at I4Ultimate.com
Learn about commuter options in Central Florida at reThinkYourCommute.com

