



BUILDING A BETTER I-4

Stay Informed:

- » Project Hotline: 844-ULT-INFO (858-4636)
- » Sign up for email and text alerts at fdot.tips/I4Alerts
- » Follow @i4Ultimate on Twitter
- » View our weekly construction update video at fdot.tips/I4Video
- » Subscribe to our monthly newsletter at fdot.tips/I4News

EASTBOUND I-4 THROUGH DOWNTOWN ORLANDO CLOSING AT NIGHT

NIGHTTIME CLOSURE OF EASTBOUND INTERSTATE 4 (I-4) BETWEEN GORE STREET AND AMELIA STREET TO OCCUR JANUARY 6-7

The Florida Department of Transportation is temporarily closing at night eastbound I-4 between Gore Street and Amelia Street. The closure will occur from 12 a.m. to 5 a.m. on January 6, and Sunday, January 7. Law enforcement officers will monitor each signaled intersection on the detour route of Garland Avenue between South Street and Colonial Drive (State Road [S.R.] 50) to promote traffic flow. In addition, the westbound and eastbound S.R. 408 exit ramps to eastbound I-4, the eastbound I-4 exit ramp to Amelia Street and eastbound I-4 entrance ramp from Anderson Street will be closed from 10 p.m. to 5 a.m. as soon as January 5-7. The closures are necessary to remove an overhead sign structures over I-4. Rolling roadblocks on westbound I-4 (see other side of handout) from Maitland Boulevard (S.R. 414) to Central Boulevard will occur between 12 a.m. and 5 a.m. on January 6-7 to aid in the removal of the sign structures.

Traveling Eastbound on I-4:

- Exit eastbound I-4 at Exit 82B onto South Street
- Continue northbound on Garland Avenue
- Enter eastbound I-4 from Garland Avenue just beyond Amelia Street

Traveling Eastbound on S.R. 408:

- Exit eastbound S.R. 408 at Exit 10C
- Keep right and merge onto Lucerne Circle
- Turn right onto Orange Avenue, which becomes Rosalind Avenue
- Continue on Rosalind Avenue, which becomes Magnolia Avenue
- Enter eastbound I-4 from Magnolia Avenue

Traveling Westbound on S.R. 408:

- Exit westbound S.R. 408 at Exit 11A
- At end of ramp, turn left onto South Street
- Turn right onto Garland Avenue
- Enter eastbound I-4 from Garland Avenue just beyond Amelia Street

Traveling on Westbound Anderson Street to Eastbound I-4:

- Turn right onto Division Avenue
- Turn right onto South Street
- Turn left onto Garland Avenue
- Enter eastbound I-4 from Garland Avenue just beyond Amelia Street

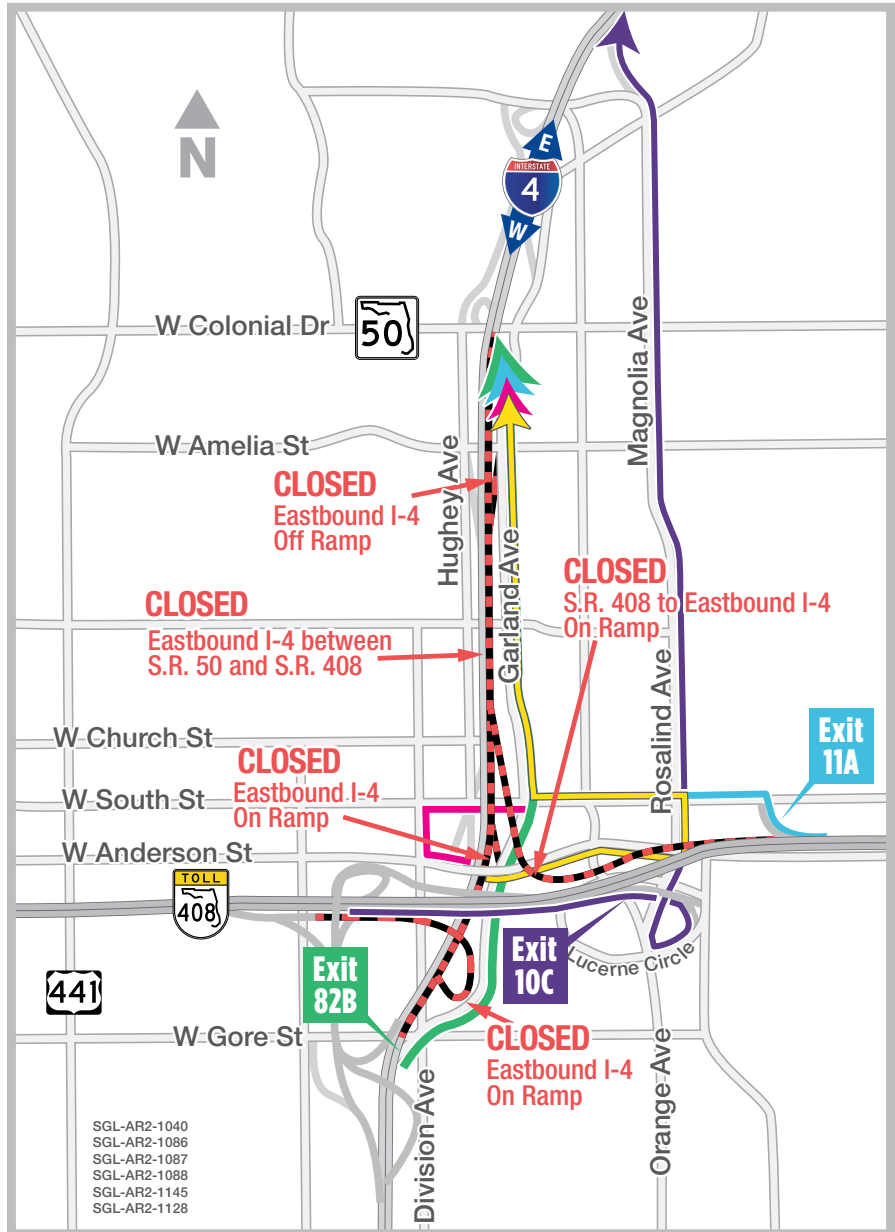

Traveling on Eastbound Anderson Street to Eastbound I-4:

- Turn left onto Rosalind Avenue
- Turn left onto South Street
- Turn right onto Garland Avenue
- Enter eastbound I-4 from Garland Avenue just beyond Amelia Street



Sign up for I-4 Construction Updates and Alerts at I4Ultimate.com
Learn about commuter options in Central Florida at reThinkYourCommute.com





BUILDING A BETTER I-4

Stay Informed:

- » Project Hotline: 844-ULT-INFO (858-4636)
- » Sign up for email and text alerts at fdot.tips/I4Alerts
- » Follow @i4Ultimate on Twitter
- » View our weekly construction update video at fdot.tips/I4Video
- » Subscribe to our monthly newsletter at fdot.tips/I4News

WESTBOUND I-4 ROLLING ROADBLOCK FROM MAITLAND BOULEVARD TO S.R. 408

Rolling roadblocks on westbound Interstate 4 (I-4) from Maitland Boulevard (State Road 414) to State Road (S.R.) 408 are scheduled between 12 a.m. and 5 a.m. for as many as two nights beginning November 12. To ensure no vehicles jump ahead of the rolling roadblock, westbound I-4 entrance ramps will be temporarily blocked by law enforcement officers. As the pace car passes an interchange, its westbound I-4 entrance ramp will be reopened allowing motorists to enter and join the slow roll. The rolling roadblock and temporary closures of westbound I-4 entrance ramps create a 30-minute window for crews to remove two overhead sign structures over I-4. Multiple rolling roadblocks are scheduled to occur. Public safety vehicles (law enforcement, fire rescue, etc.) are permitted to skip past the rolling roadblock to respond to an emergency call. A detour of eastbound I-4 (see other side of handout) from Gore Street to Amelia Street will occur between 12 a.m. and 5 a.m. on the same night(s) to aid in the removal of the sign structures.

TEMPORARY WESTBOUND I-4 RAMP CLOSURES

1	WB & EB Maitland Blvd (S.R. 414)
2	Lee Rd (S.R. 423)
3	Fairbanks Ave (S.R. 426)
4	Par St
5	Princeton St
6	Ivanhoe Blvd
7	Colonial Dr (S.R. 50)
8	Amelia St

WESTBOUND I-4 RAMP CLOSURES

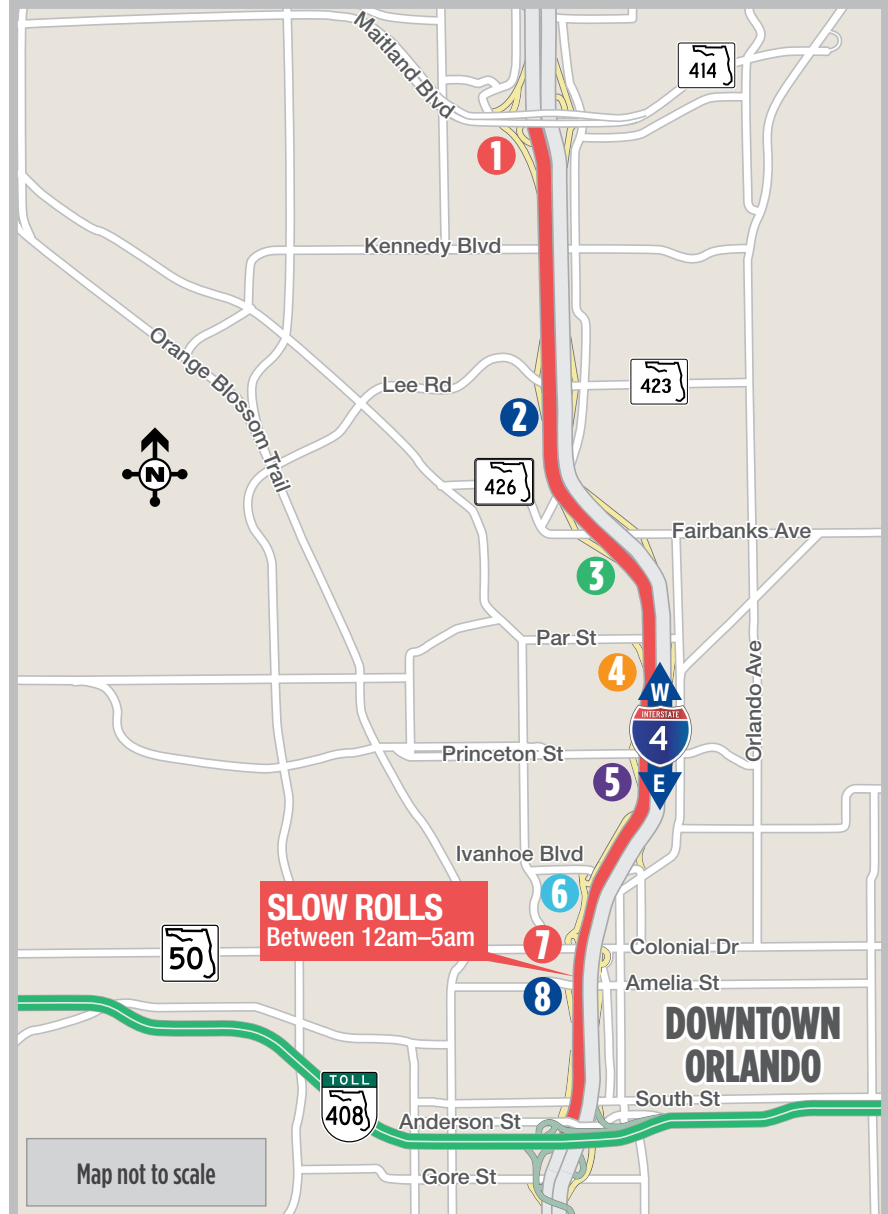

Closure subject to change. Construction progress, roadway conditions and weather may require schedule adjustments. Please check i4ultimate.com/alertsmap for the most up-to-date information.



Sign up for I-4 Construction Updates and Alerts at I4Ultimate.com
Learn about commuter options in Central Florida at reThinkYourCommute.com

