



# BUILDING A BETTER I-4

## Stay Informed:

- » Project Hotline: 844-ULT-INFO (858-4636)
- » Sign up for email and text alerts at [fdot.tips/I4Alerts](https://fdot.tips/I4Alerts)
- » Follow @i4Ultimate on Twitter
- » Subscribe to our monthly newsletter at [fdot.tips/I4News](https://fdot.tips/I4News)

## EB I-4 EXIT RAMP TO SOUTH STREET COMBINING WITH EXIT TO S.R. 408 AS SOON AS APRIL 18

The temporary configuration of the eastbound Interstate 4 (I-4) exit ramps to State Road (S.R.) 408 (Exit 82A) and South Street (Exit 82B) will open as soon as the morning of Thursday, April 18. The temporary configuration will move the eastbound I-4 exit to South Street approximately one-quarter mile and combine it with the eastbound I-4 exit to S.R. 408. The exit ramp will consist of two lanes with the right lane continuing to South Street and the left lane heading toward S.R. 408.

This temporary ramp configuration will be in place for approximately 18 months, giving construction crews a safe workspace to demolish the old bridge over Division Avenue that the ramp will no longer use.

More info:  
[i4ultimate.com/exit82](https://i4ultimate.com/exit82)

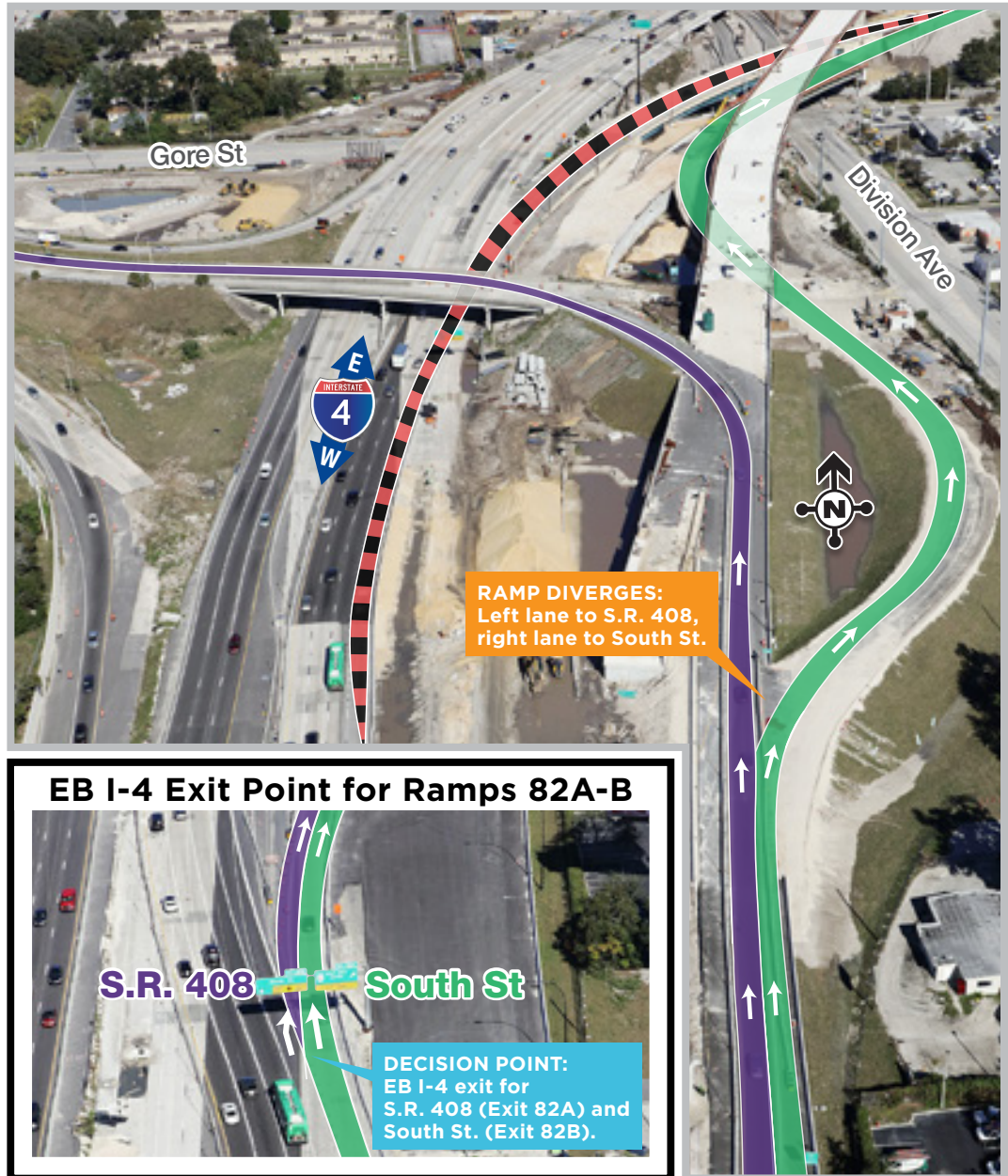

Ramp shift subject to change. Construction progress, roadway conditions and weather may require schedule adjustments.  
Please check [i4ultimate.com/alertsmap](https://i4ultimate.com/alertsmap) for the most up-to-date information.



Sign up for I-4 Construction Updates and Alerts at [I4Ultimate.com](https://I4Ultimate.com)  
Learn about commuter options in Central Florida at [reThinkYourCommute.com](https://reThinkYourCommute.com)

