



BUILDING A BETTER I-4

Stay Informed:

- » Project Hotline: 844-ULT-INFO (858-4636)
- » Sign up for email and text alerts at fdot.tips/I4Alerts
- » Follow @i4Ultimate on Twitter
- » Subscribe to our monthly newsletter at fdot.tips/I4News

EB I-4 EXIT RAMP TO AMELIA STREET SHIFTING TO TEMPORARY LOCATION

The eastbound Interstate 4 (I-4) exit to Amelia Street (Exit 83A) is shifting to a temporary configuration as soon as the morning of April 3, and will be in place for about 18 months. The exit point from I-4 to the new temporary ramp is just past Amelia Street and will place motorists on a separate travel lane partitioned from Garland Avenue by a barrier wall. This interim configuration is necessary to continue construction of the new eastbound I-4 travel lanes through downtown Orlando. For more information, visit i4Ultimate.com/Amelia.

PROJECT INFO

The \$2.3 billion I-4 Ultimate project is reconstructing 21 miles of interstate from west of Kirkman Road to east of State Road 434 in Longwood. For more information about I-4 Ultimate, contact David Parks, I-4 Ultimate Public Information Officer, at 844-ULT-INFO (844-858-4636) or DavidParks@i4Ultimate.com.

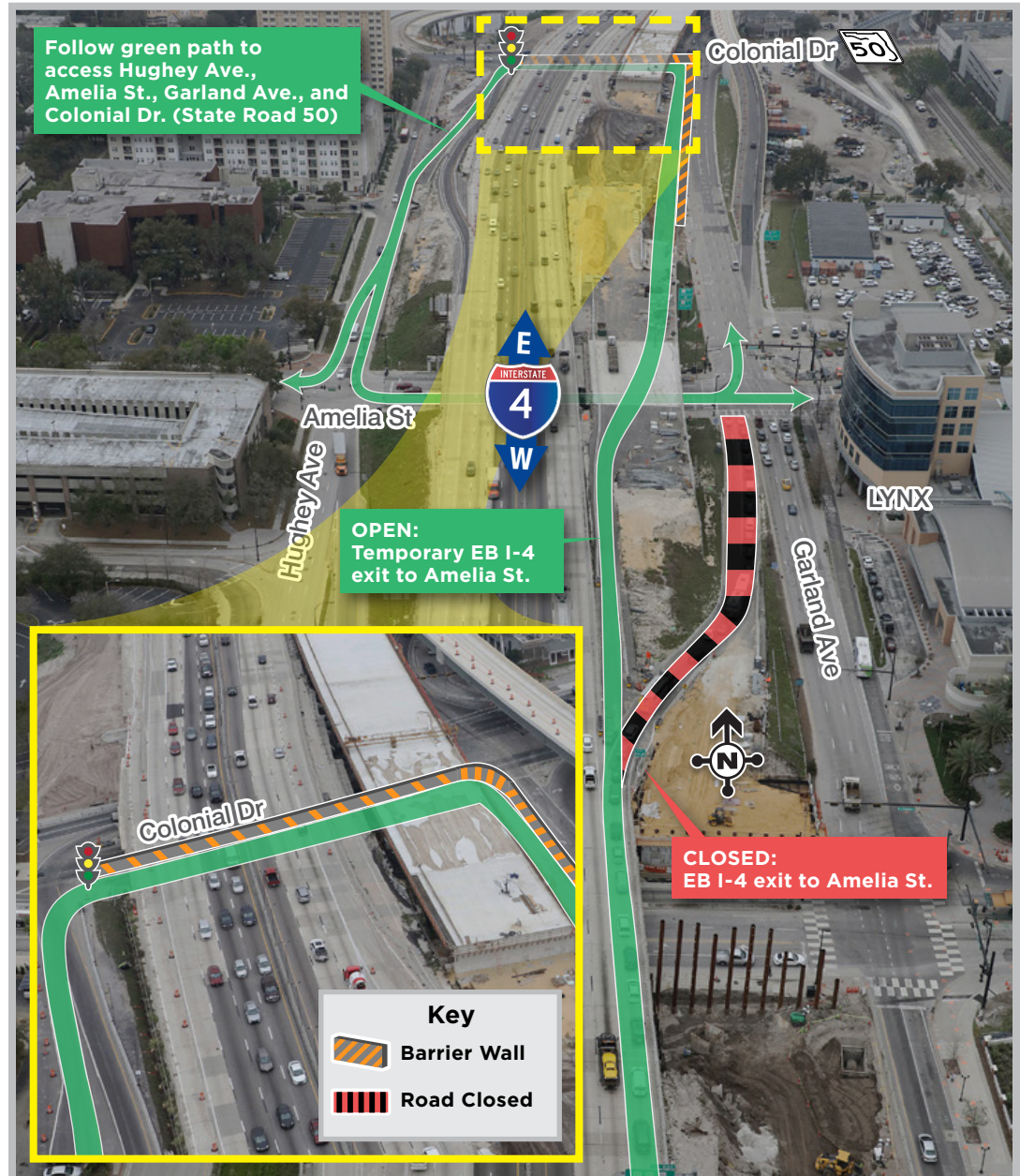

Closure subject to change. Construction progress, roadway conditions and weather may require schedule adjustments.

Please check i4ultimate.com/alertsmap for the most up-to-date information.



Sign up for I-4 Construction Updates and Alerts at I4Ultimate.com
Learn about commuter options in Central Florida at reThinkYourCommute.com





BUILDING A BETTER I-4

Stay Informed:

- » Project Hotline: 844-ULT-INFO (858-4636)
- » Sign up for email and text alerts at fdot.tips/I4Alerts
- » Follow @i4Ultimate on Twitter
- » Subscribe to our monthly newsletter at fdot.tips/I4News

ALTERNATE ACCESS ROUTES FOR MOTORISTS EXITING EASTBOUND I-4 AT EXIT 83A

The interim configuration of the eastbound Interstate 4 (I-4) exit to Amelia Street (Exit 83A) may require some motorists to alter their route to nearby areas. The temporary configuration of the ramp will have motorists exit to a partitioned roadway adjacent to Garland Avenue. Motorists seeking to access other nearby areas may follow a new route. The eastbound I-4 exit ramp to South Street (Exit 82B) will remain open, and may be an option for motorists.

To north Orange Avenue, north of Colonial Drive:

- From end of exit ramp, follow U-turn lane to Hughey Avenue
- Turn left onto Amelia Street
- Turn left onto Garland Avenue

To eastbound Colonial Drive:

- From end of exit ramp, follow U-turn lane to Hughey Avenue
- Turn left onto Amelia Street
- Turn left onto Garland Avenue
- Turn right onto Colonial Drive

To downtown Orlando via Amelia Street:

- From end of exit ramp, follow U-turn lane to Hughey Avenue
- Turn left or right onto Amelia Street

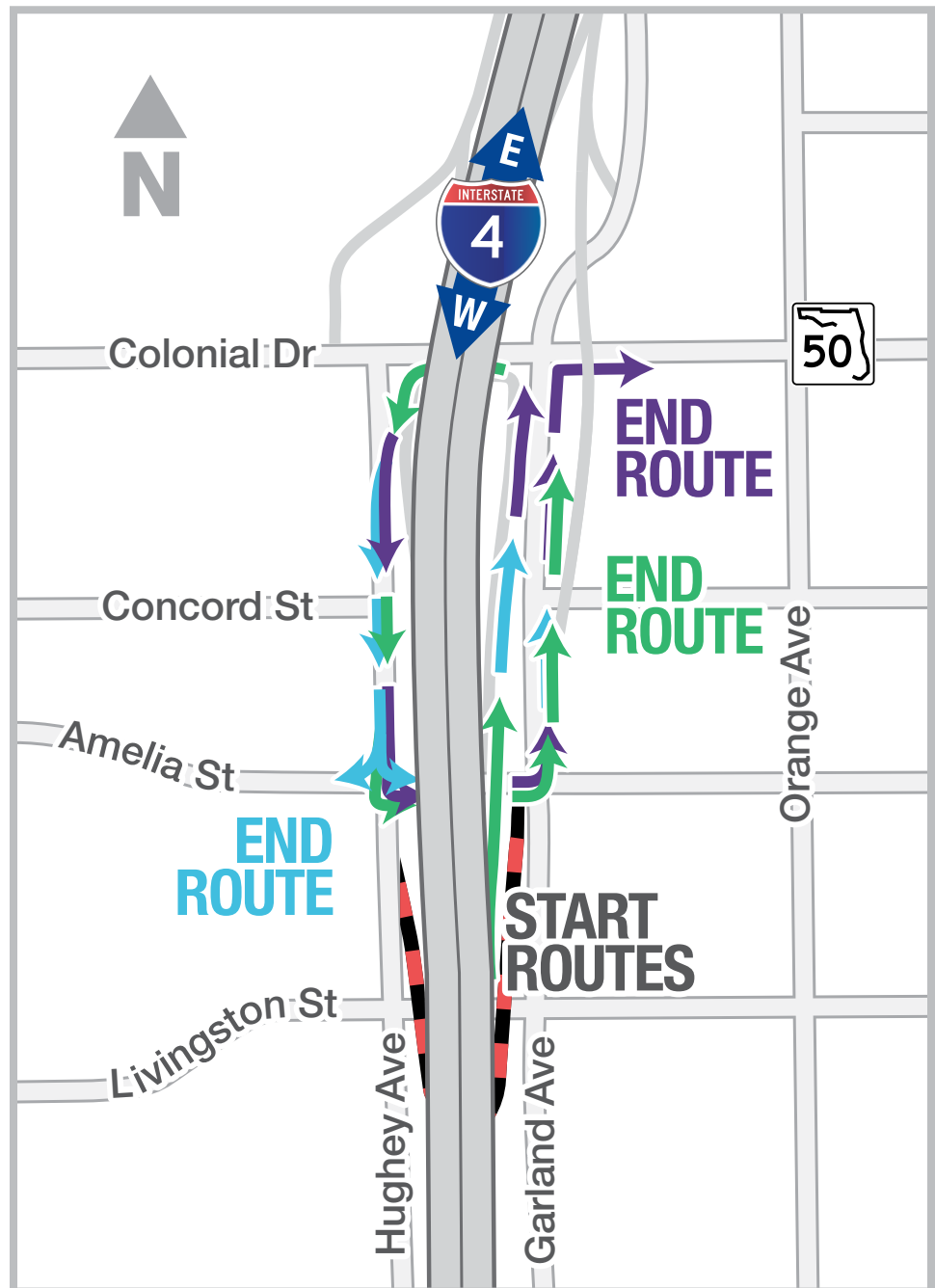

Sign up for I-4 Construction Updates and Alerts at I4Ultimate.com
Learn about commuter options in Central Florida at reThinkYourCommute.com

